

ANDRY PULLEY

PULLEY

Ref. 0108

GENERAL

A light-duty steel pulley designed to be used for tensioning safety nets. For use with ropes up to 12 mm in diameter. Efficiency: 70%. Carbon steel body and axle, polyamide wheel.



MBL 22 kN WLL 3 kN

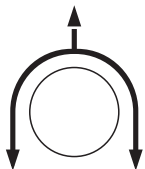

WLL 1.5 kN WLL 1.5 kN

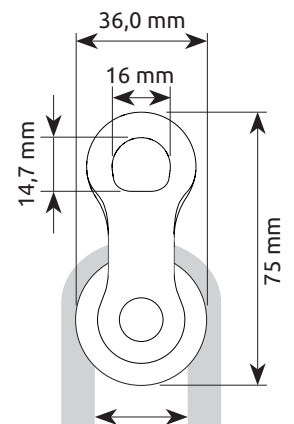

Ref.	Product name	Weight		Inner sheave diameter	Rope diameter	Working load max	Breaking load	CE
		g	oz					
0108	ANDRY	100	3.5	26	12	1.5 kN x 2 = 3 kN	22	•