

# CABLE FALL ARRESTER

FALL ARRESTER

Ref. 1317

TOWERS/INDUSTRY

Auto-locking fall arrester for use on 8 mm diameter stainless steel 7x19 cable. The device will trail the user during ascension and lock automatically in the event of a fall. Must be used in combination with an EN 355 certified energy absorber (ref.102901).

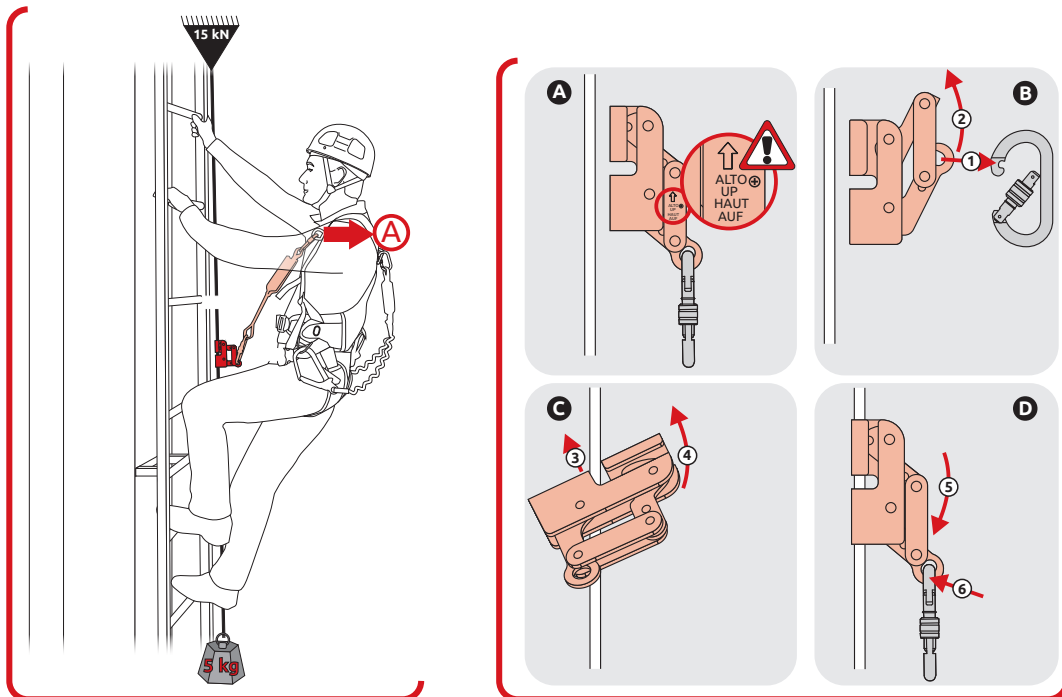
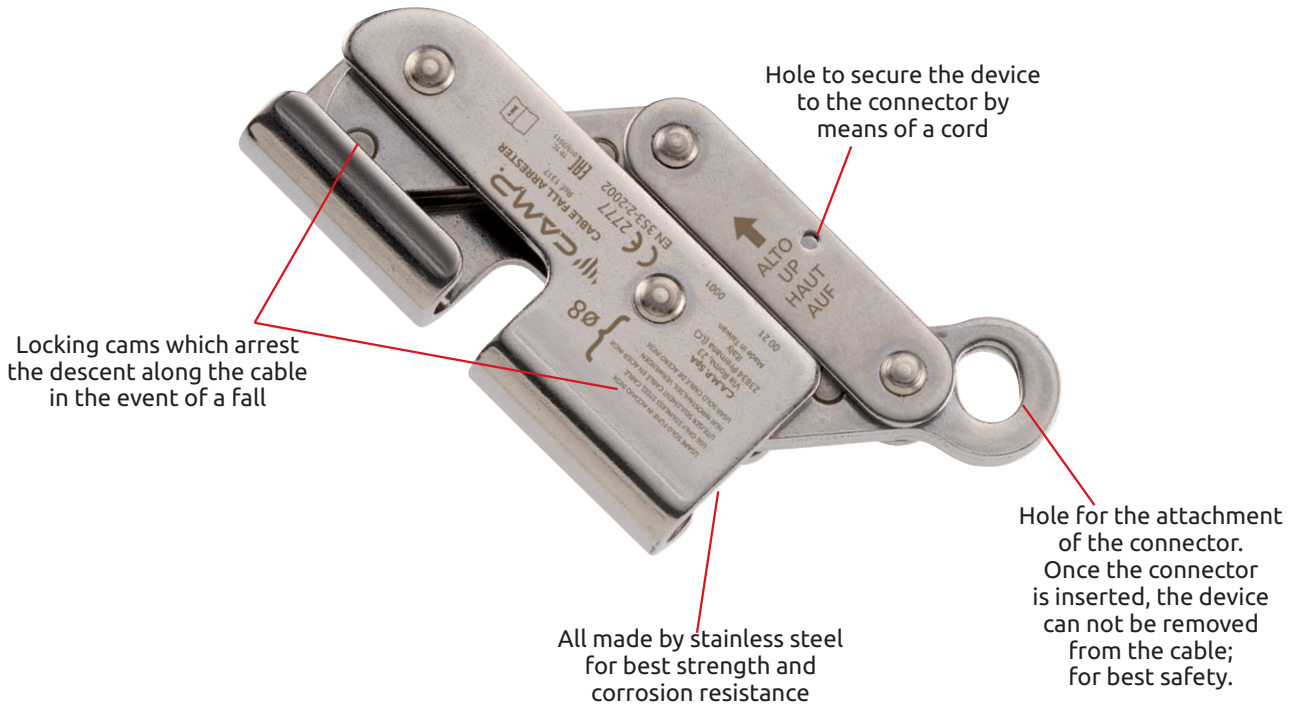

Ref.	Product name	Weight		CE	EN 353-2	EAC
		g	oz			
1317	CABLE FALL ARRESTER	480	16.9	•	•	•